

Single Row NU, NJ, NUP, N, NF Series

Cylindrical Roller Bearings

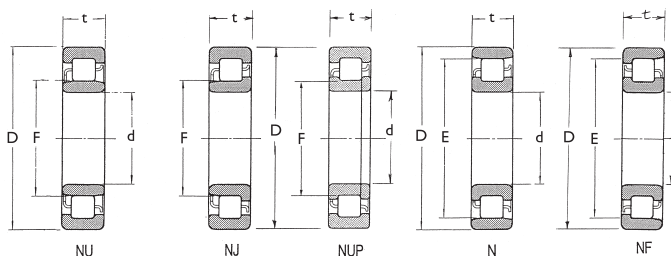

Bearing Number	Dimensions (mm)					Basic Load Ratings (N)		Limiting Speeds (rev/min)		Weight kg
	d	D	t	F	E	Cr	Cor	Grease	Oil	
NU 204 NJ NUP N NF	20	47	14	27	40	15400	12700	15000	18000	0.110
NU 2204 NJ NUP - -	20	47	18	27	-	20700	18400	13000	16000	0.144
NU 304 NJ NUP N NF	20	52	15	28.5	44.5	21400	17300	12000	15000	0.150
NU 2304 NJ NUP - -	20	52	21	28.5	-	21400	27200	11000	14000	0.217
NU 1005 - - - -	25	47	12	30.5	-	14300	13100	15000	18000	0.094
NU 205 NJ NUP N NF	25	52	15	32	45	17700	15700	13000	16000	0.137
NU 2205 NJ NUP - -	25	52	18	32	-	23700	22800	12000	14000	0.167
NU 305 NJ NUP N NF	25	62	17	35	53	29300	25200	10000	13000	0.240
NU 2305 NJ NUP - -	25	62	24	35	-	42500	41000	9000	11000	0.345
NU 1006 - - N -	30	55	13	36.5	48.5	19700	19600	12000	15000	0.136
NU 206 NJ NUP - -	30	62	16	38.5	-	23500	21500	11000	13000	0.211
NU 2206 NJ NUP - -	30	62	20	38.5	-	33000	33000	10000	12000	0.266
NU 306 NJ NUP N NF	30	72	19	42	62	38500	35000	8500	11000	0.361
NU 2306 NJ NUP - -	30	72	27	42	-	51500	51000	7500	9500	0.514
NU 1007 - - N -	35	62	14	42	55	22600	23200	11000	13000	0.180
NU 207 NJ NUP - -	35	72	17	43.8	-	33500	31500	9500	11000	0.300
NU 2207 NJ NUP - -	35	72	23	43.8	-	49000	51000	8500	10000	0.414
NU 307 NJ NUP N NF	35	80	21	46.2	68.2	49500	47000	8000	9500	0.481
NU 2307 NJ NUP - -	35	80	31	46.2	-	60500	60000	7100	8500	0.702
NU 1008 - - N -	40	68	15	47	61	27300	29000	10000	12000	0.223
NU 208 NJ NUP N NF	40	80	18	50	70	43500	43000	8500	10000	0.382
NU 2208 NJ NUP - -	40	80	23	50	-	58000	62000	7500	9000	0.496
NU 308 NJ NUP N NF	40	90	23	53.5	77.5	58500	57000	6700	8500	0.665
NU 2308 NJ NUP - -	40	90	33	53.5	-	82500	88000	6000	7500	0.962
NU 1009 - - N -	45	75	16	52.5	67.5	32500	35500	9000	11000	0.279
NU 209 NJ NUP N NF	45	85	19	55	75	46000	47000	7500	9000	0.438
NU 2209 NJ NUP - -	45	85	23	55	-	61500	68000	7100	8500	0.541
NU 309 NJ NUP - -	45	100	25	58.5	-	74000	71000	6300	7500	0.876

*The bearing is available in maximum capacity design, add Suffix 'E' or machine brass cage, add suffix 'M'

Cylindrical Roller Bearings

Single Row NU, NJ, NUP, N, NF Series

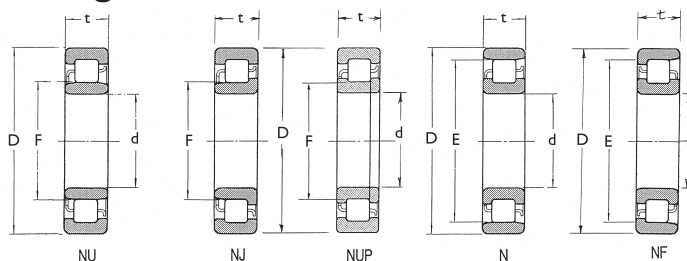

Ball / Roller Bearing

Bearing Number	Dimensions (mm)					Basic Load Ratings (N)		Limiting Speeds (rev/min)		Weight kg
	d	D	t	F	E	Cr	Cor	Grease	Oil	
NU 2309 NJ NUP - -	45	100	36	58.5	-	99000	104000	5600	6700	1.260
NU 1010 - - N -	50	80	16	57.5	72.5	32000	36000	8000	10000	0.301
NU 210 NJ NUP N NF	50	90	20	60.4	80.4	48000	51000	7100	8500	0.493
NU 2210 NJ NUP - -	50	90	23	60.4	-	64000	73500	6300	8000	0.580
NU 310 NJ NUP N NF	50	110	27	65	95	87000	86000	5600	6700	1.140
NU 2310 NJ NUP - -	50	110	40	65	-	121000	131000	5000	6300	1.690
NU 1011 - - N -	55	90	18	64.5	80.5	37500	44000	7500	9000	0.445
NU 211 NJ NUP N NF	55	100	21	66.5	88.5	58000	62500	6300	7500	0.648
NU 2211 NJ NUP - -	55	100	25	66.5	-	75500	87000	6000	7100	0.786
NU 311 NJ NUP N NF	55	120	29	70.5	104.5	111000	111000	5000	6300	1.450
NU 2311 NJ NUP - -	55	120	43	70.5	-	148000	162000	4500	5600	2.160
NU 1012 - - N -	60	95	18	69.5	85.5	40000	48500	6700	8500	0.474
NU 212 NJ NUP N NF	60	110	22	73.5	97.5	68500	75000	6000	7100	0.840
NU 2212 NJ NUP - -	60	110	28	73.5	-	96000	116000	5300	6300	1.090
NU 312 NJ NUP N NF	60	130	31	77	113	124000	126000	4800	5600	1.820
NU 2312 NJ NUP - -	60	130	46	77	-	169000	188000	4300	5300	2.690
NU 1013 - - N -	65	100	18	74.5	90.5	41000	51000	6300	8000	0.504
NU 213 NJ NUP N NF	65	120	23	79.6	105.6	84000	94500	5300	6300	1.070
NU 2213 NJ NUP - -	65	120	31	79.6	-	120000	149000	4800	6000	1.470
NU 313 NJ NUP N NF	65	140	33	83.5	121.5	135000	139000	4300	5300	2.230
NU 2313 NJ NUP - -	65	140	48	83.5	-	188000	212000	3800	4800	3.250
NU 1014 - - N -	70	110	20	80	100	58500	70500	6000	7100	0.693
NU 214 NJ NUP N NF	70	125	24	84.5	110.5	83500	95000	5000	6300	1.160
NU 2214 NJ NUP - -	70	125	31	84.5	-	119000	151000	4500	5600	1.540
NU 314 NJ NUP - -	70	150	35	90	-	158000	168000	4000	5000	2.750
NU 2314 NJ NUP - -	70	150	51	90	-	223000	262000	3600	4500	4.040

*The bearing is available in maximum capacity design, add Suffix 'E' or machine brass cage, add suffix 'M'

**Single Row
NU, NJ, NUP,
N, NF Series**

Cylindrical Roller Bearings

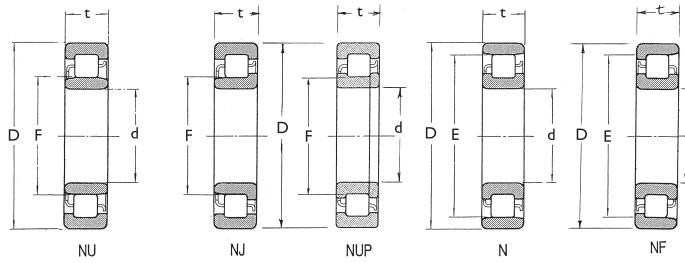

Bearing Number	Dimensions (mm)					Basic Load Ratings (N)		Limiting Speeds (rev/min)		Weight kg				
	d	D	t	F	E	Cr	Cor	Grease	Oil					
NU 1015	-	-	N	-	75	115	20	85	105	60000	74500	5600	6700	0.731
NU 215	NJ	NUP	N	NF	75	130	25	88.5	116.5	96500	111000	4800	6000	1.250
NU 2215	NJ	NUP	-	-	75	130	31	88.5	-	130000	162000	4300	5300	1.580
NU 315	NJ	NUP	N	NF	75	160	37	95.5	139.5	179000	189000	3800	4800	3.260
NU 2315	NJ	NUP	-	-	75	160	55	95.5	-	258000	300000	3400	4300	4.910
NU 1016	-	-	N	-	80	125	22	91.5	113.5	72500	90500	5300	6300	0.969
NU 216	NJ	NUP	N	NF	80	140	26	95.3	125.3	106000	122000	4500	5300	1.500
NU 2216	NJ	NUP	-	-	80	140	33	95.3	-	147000	186000	4000	5000	1.950
NU 316	NJ	NUP	N	NF	80	170	39	103	147	190000	207000	3600	4300	3.930
NU 2316	NJ	NUP	-	-	80	170	58	103	-	274000	330000	3200	4000	5.910
NU 1017	-	-	N	-	85	130	22	96.5	118.5	74500	95500	5000	6000	1.010
NU 217	NJ	NUP	N	NF	85	150	28	101.8	133.8	120000	140000	4300	5000	1.900
NU 2217	NJ	NUP	-	-	85	150	36	101.8	-	170000	218000	3800	4500	2.500
NU 317	NJ	NUP	N	NF	85	180	41	108	156	212000	228000	3400	4000	4.600
NU 2317	NJ	NUP	-	-	85	180	60	108	-	315000	380000	3000	3800	6.81
NU 1018	-	-	N	-	90	140	24	103	127	88000	114000	4500	5600	1.35
NU 218	NJ	NUP	N	NF	90	160	30	107	143	152000	178000	4000	4800	2.35
NU 2218	NJ	NUP	-	-	90	160	40	107	-	207000	265000	3600	4300	3.18
NU 318	NJ	NUP	N	NF	90	190	43	115	165	240000	265000	3200	3800	5.38
NU 2318	NJ	NUP	-	-	90	190	64	115	-	325000	395000	2800	3600	8.04
NU 1019	-	-	N	-	95	145	24	108	132	90500	120000	4300	5300	1.41
NU 219	NJ	NUP	-	-	95	170	32	113.5	-	158000	183000	3800	4500	2.80
NU 2219	NJ	NUP	-	-	95	170	43	113.5	-	230000	298000	3400	4000	3.89
NU 319	NJ	NUP	N	NF	95	200	45	121.5	173.5	259000	289000	3000	3600	6.23
NU 2319	NJ	NUP	-	-	95	200	67	121.5	-	370000	460000	2600	3400	9.38
NU 1020	-	-	N	-	100	150	24	113	137	93000	126000	4300	5300	1.47
NU 220	NJ	NUP	N	NF	100	180	34	120	160	183000	217000	3600	4300	3.42
NU 2220	NJ	NUP	-	-	100	180	46	120	-	246000	315000	3200	3800	4.68
NU 320	NJ	NUP	N	NF	100	215	47	129.5	185.5	299000	335000	2800	3400	7.69
NU 2320	NJ	NUP	-	-	100	215	73	129.5	-	410000	505000	2400	3200	11.90
NU 1021	-	-	N	-	105	160	26	119.5	145.5	109000	149000	4000	4800	1.83
NU 221	NJ	NUP	N	NF		190	36	126.8	168.8	201000	241000	3400	4000	4.07
NU 321	NJ	NUP	N	NF		225	49	135	195	320000	360000	2600	3200	8.68
NU 1022	-	-	N	-	110	170	28	125	155	131000	174000	3800	4500	2.27
NU 222	NJ	NUP	N	NF		200	38	132.5	178.5	229000	272000	3200	3800	4.73
NU 2222	NJ	NUP	-	-		200	53	132.5	-	320000	415000	2800	3400	6.68
NU 322	NJ	NUP	N	NF		240	50	143	207	360000	400000	2600	3000	10.3
NU 2322	NJ	NUP	-	-		240	80	143	-	570000	735000	2200	2800	18.6
NU 1024	-	-	N	-	120	180	28	135	165	139000	191000	3400	4300	2.43
NU 224	NJ	NUP	N	NF		215	40	143.5	191.5	248000	299000	3000	3400	5.65
NU 2224	NJ	NUP	-	-		215	58	143.5	-	350000	460000	2600	3200	8.34
NU 324	NJ	NUP	N	NF		260	55	154	226	450000	510000	2200	2800	13.2
NU 2324	NJ	NUP	-	-		260	86	154	-	710000	920000	2000	2600	23.4
NU 1026	-	-	N	-	130	200	33	148	182	172000	238000	3200	3800	3.66
NU 226	NJ	NUP	N	NF		230	40	156	204	258000	320000	2600	3200	6.5
NU 2226	NJ	NUP	-	-		230	64	156	-	380000	530000	2400	3000	10.5
NU 326	NJ	NUP	N	NF		280	58	167	243	500000	570000	2200	2600	16
NU 2326	NJ	NUP	-	-		280	93	167	-	840000	1130000	1900	2400	29.4

*The bearing is available in maximum capacity design, add Suffix 'E' or machine brass cage, add suffix 'M'

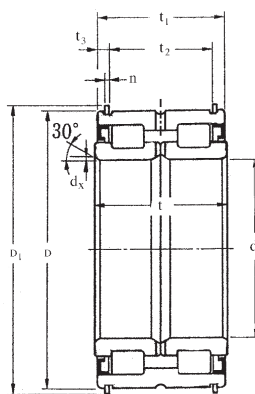

Bearing Number	Dimensions (mm)									Basic Load Ratings (N)		Limiting Speeds (rev/min)	Weight kg
	d	D	t	d_x	D_1	t_1	t_2	t_3	n	C_r	C_{or}		
SL04-5008PP.2NR	40	68	38	0.8	71.8	37	27	4.5	2.5	7400	7400	2500	0.55
SL04-5009PP.2NR	45	75	40	0.8	78.8	39	29	4.5	2.5	8850	9250	2200	0.69
SL04-5010PP.2NR	50	80	40	0.8	83.8	39	29	4.5	2.5	9300	10000	2000	0.75
SL04-5011PP.2NR	55	90	46	1.0	94.8	45	34	5.5	3.0	11000	12200	1800	1.12
SL04-5012PP.2NR	60	95	46	1.0	99.8	45	34	5.5	3.0	11400	13100	1650	1.20
SL04-5013PP.2NR	65	100	46	1.0	104.8	45	34	5.5	3.0	11900	14100	1550	1.27
SL04-5014PP.2NR	70	110	54	1.0	114.5	53	40	5.5	4.0	15900	18000	1400	1.87
SL04-5015PP.2NR	75	115	54	1.0	119.5	53	40	5.5	4.0	18200	20600	1300	1.97
SL04-5016PP.2NR	80	125	60	1.0	129.5	59	46	5.5	4.0	19000	22200	1250	2.66
SL04-5017PP.2NR	85	130	60	1.0	134.5	59	46	5.5	4.0	19800	23800	1200	2.79
SL04-5018PP.2NR	90	140	67	1.5	146.0	66	51	6.0	4.0	28300	34500	1100	3.71
SL04-5019PP.2NR	95	145	67	1.5	151.0	66	51	6.0	4.0	28900	35500	1050	3.87
SL04-5020PP.2NR	100	150	67	1.5	156.0	66	51	6.0	4.0	30500	37000	1000	4.03
SL04-5022PP.2NR	110	170	80	1.8	176.0	79	62	7.0	4.0	35500	44000	900	6.55
SL04-5024PP.2NR	120	180	80	1.8	188.0	79	63	7.0	4.0	37000	47500	850	7.50
SL04-5026PP.2NR	130	200	95	1.8	208.0	94	75	8.5	4.0	50000	63500	750	10.50
SL04-5028PP.2NR	140	210	95	1.8	218.0	94	75	8.5	5.0	55500	71000	700	11.10
SL04-5030PP.2NR	150	225	100	2.0	233.0	99	77	9.0	5.0	64000	81500	650	13.30